

	<b>A</b>	<b>B</b>	<b>C</b>	<b>H</b>
90x90x190	88,5-89	88,5-89	50	190
100x80x190	78,5-79	98,5-99	50	190

**1**

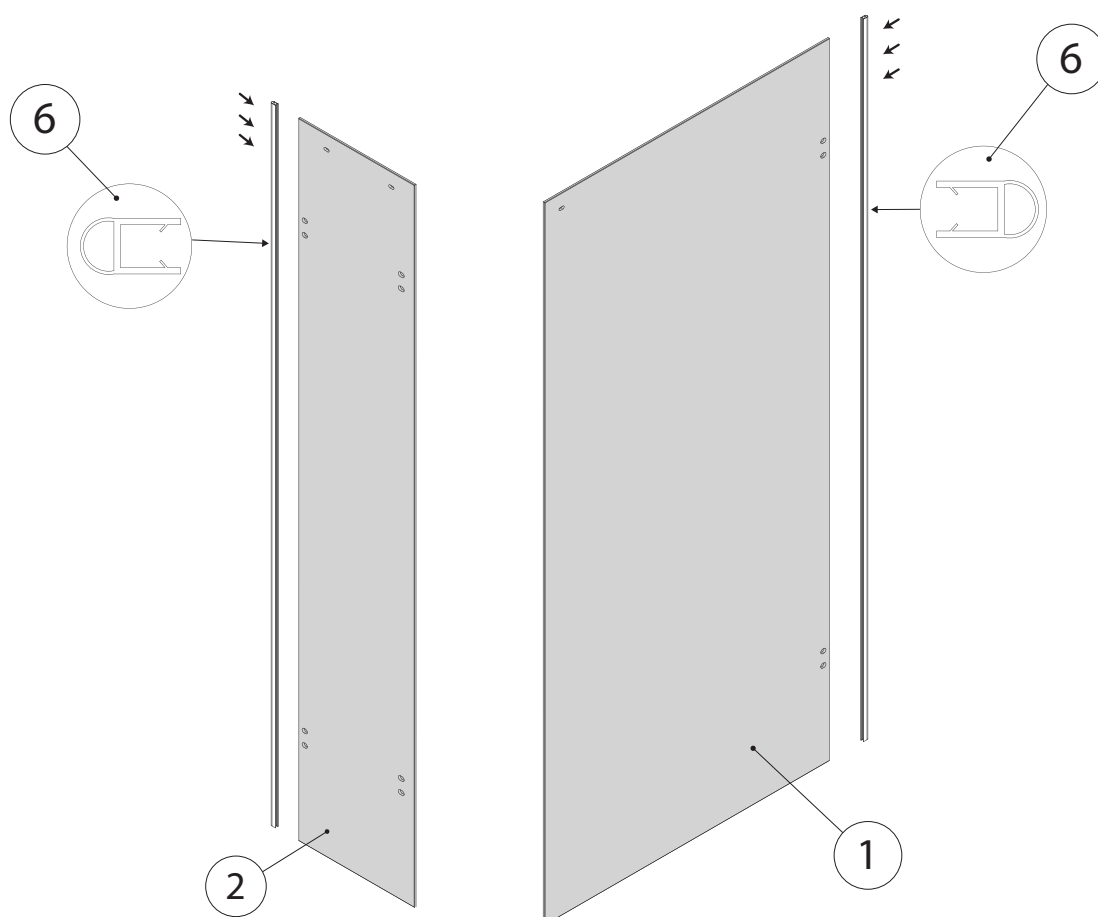

**2****x4**

SW 4,0

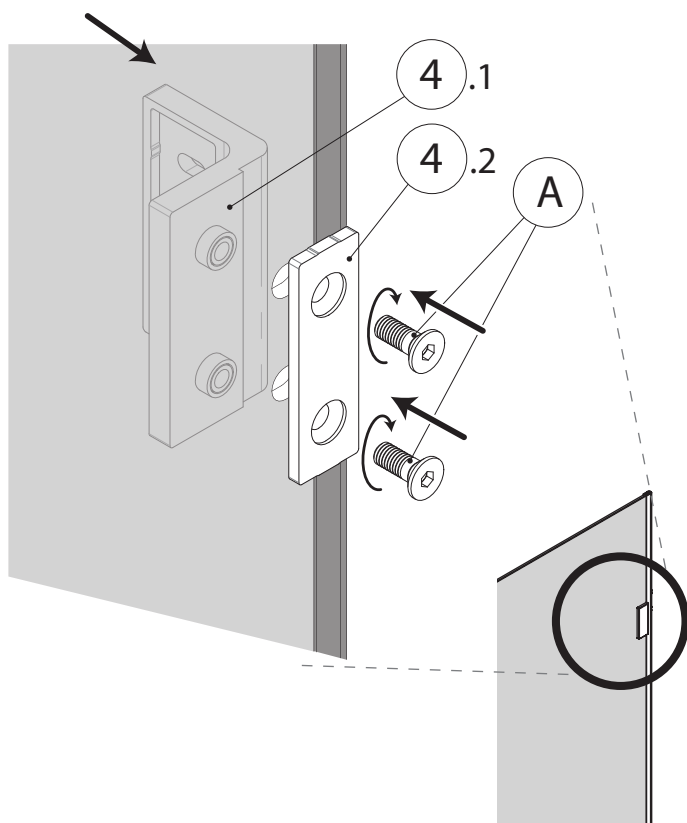
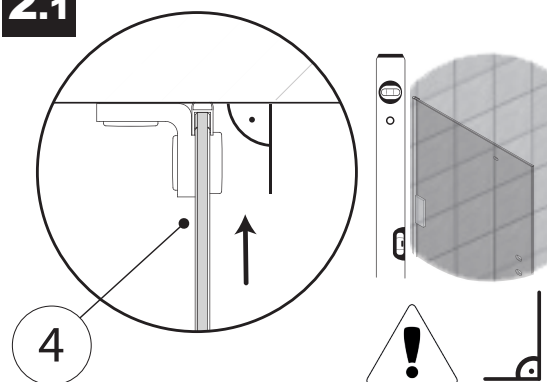
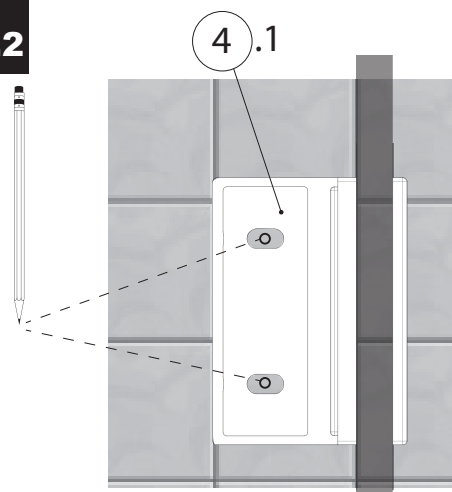
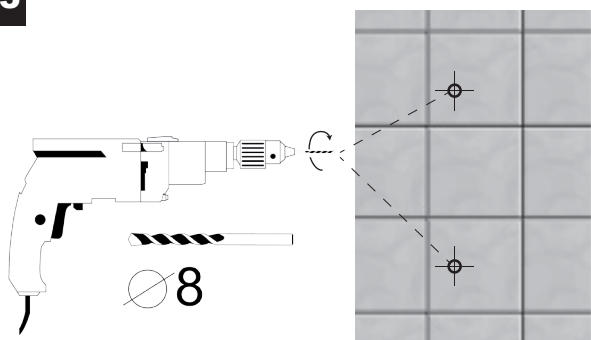
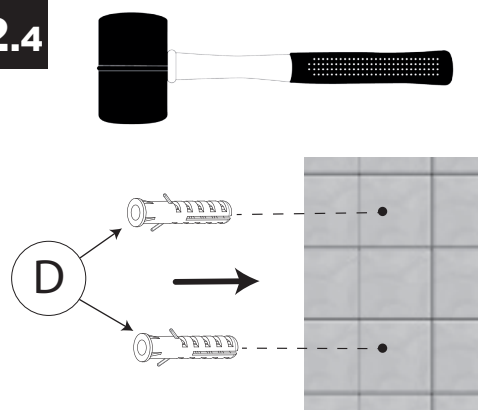
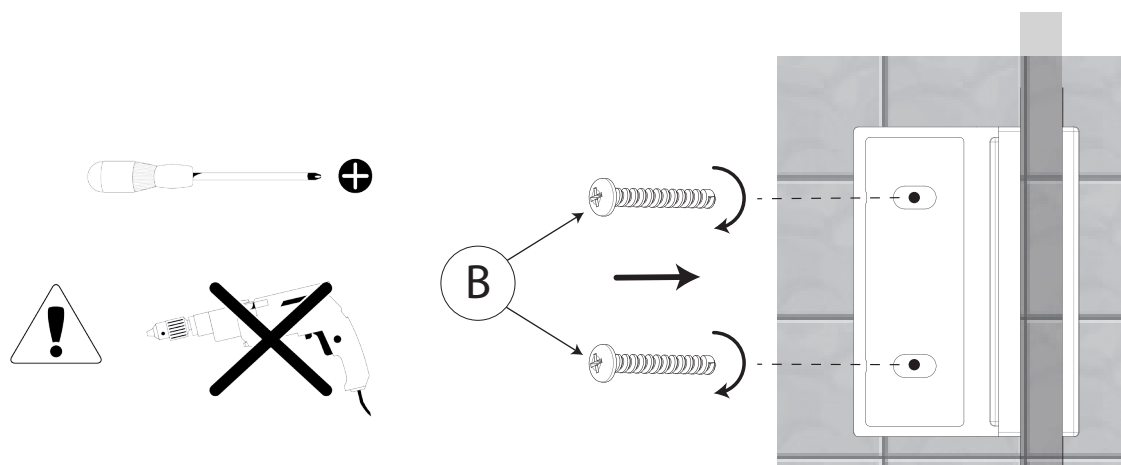
**2.1****2.2****2.3****2.4****2.5**

3

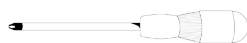
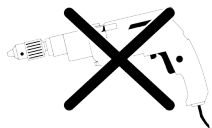

SW 4,0

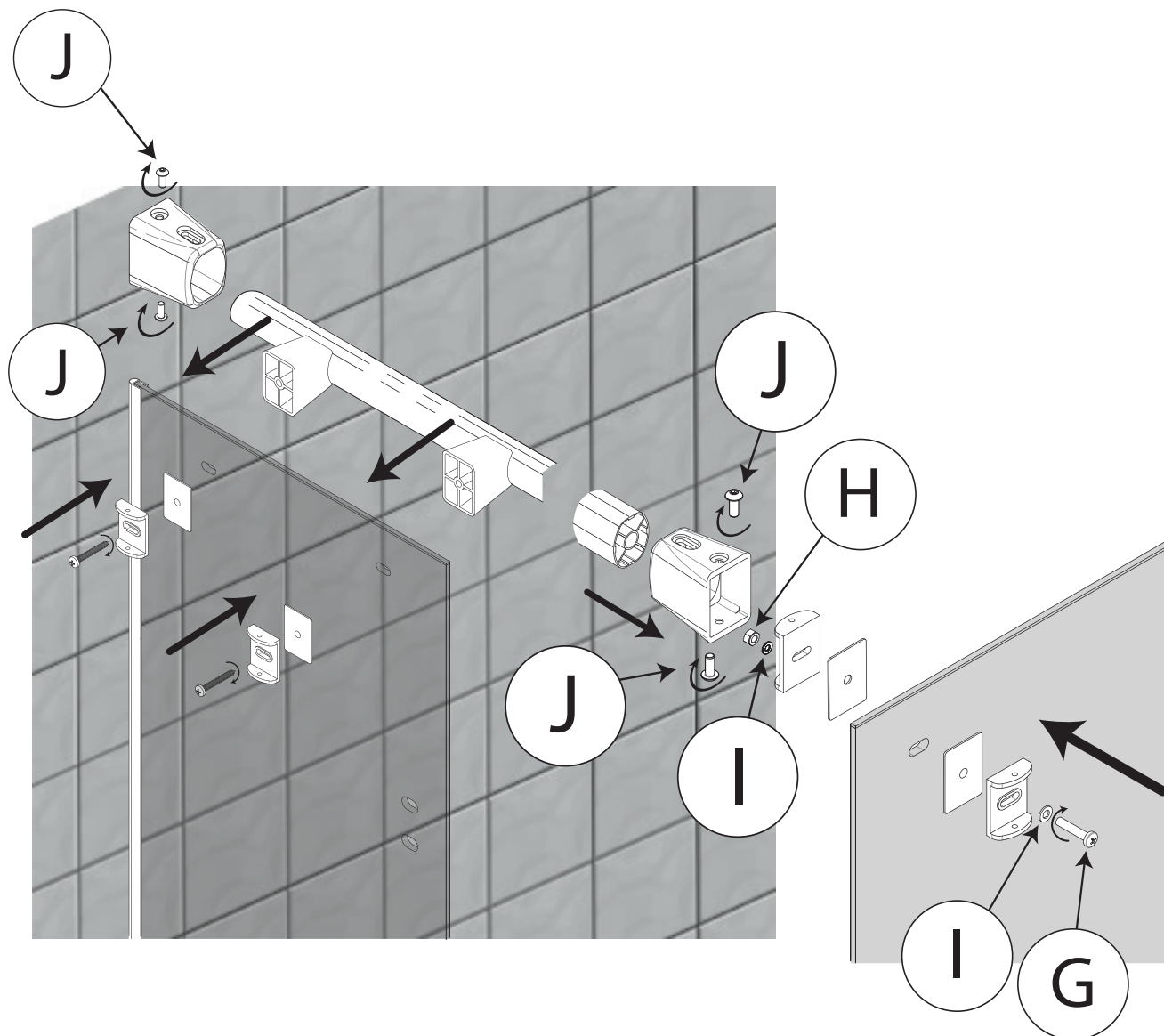

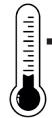
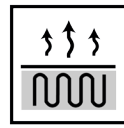

+



A diagram illustrating the application of silicone sealant. A silicone gun is shown on the left, with a tube labeled "• SILICON •". Dashed lines indicate the application of sealant into the gap between the door frame and the wall. Arrows point to the specific areas where the sealant is being applied.

9.5

K/C

K = 

C = 

## 4.3

9.5

**5**

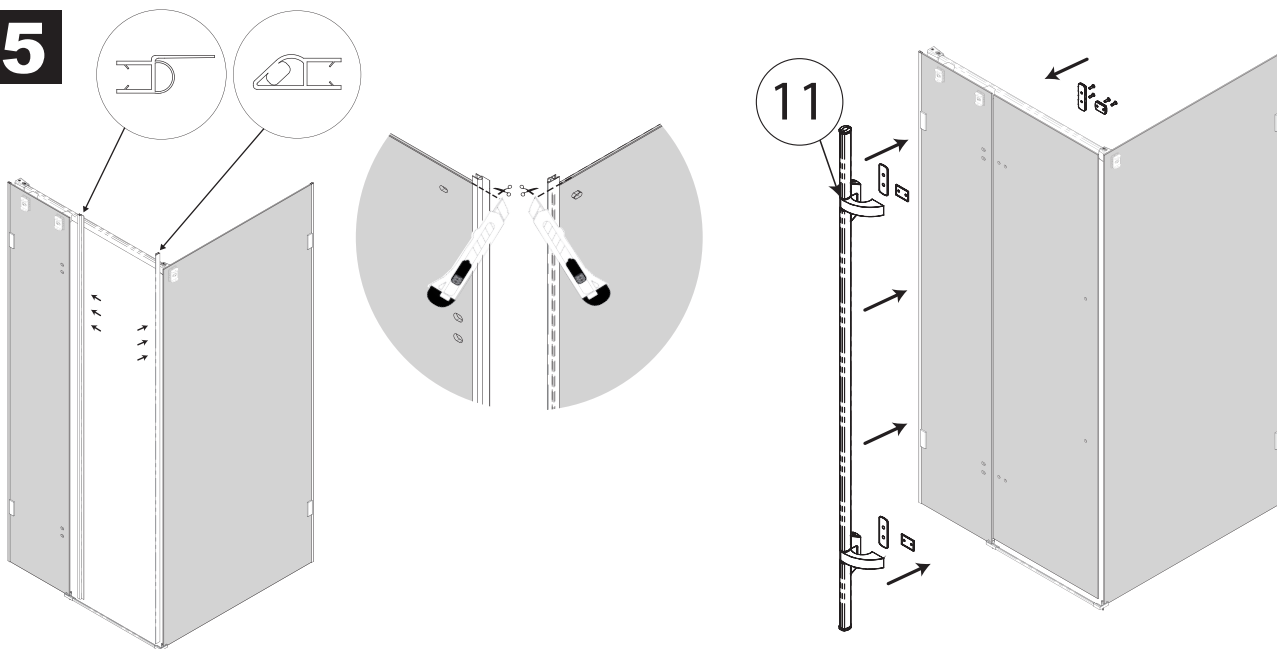

**5.1**

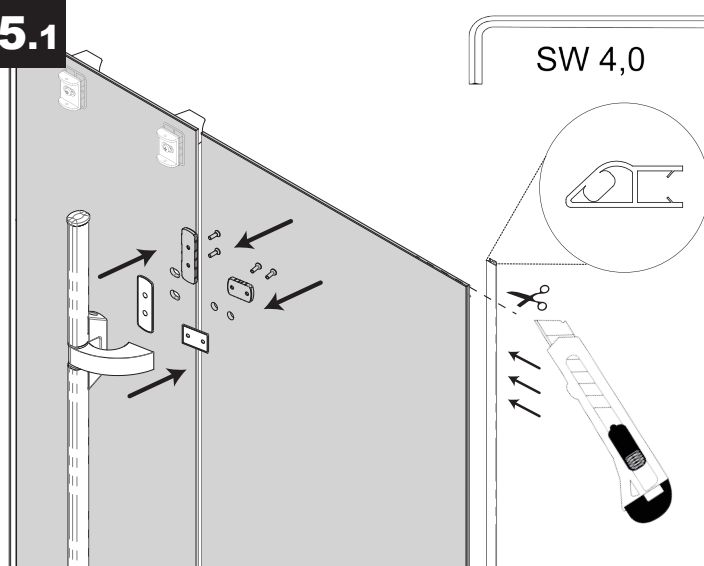

**5.2**

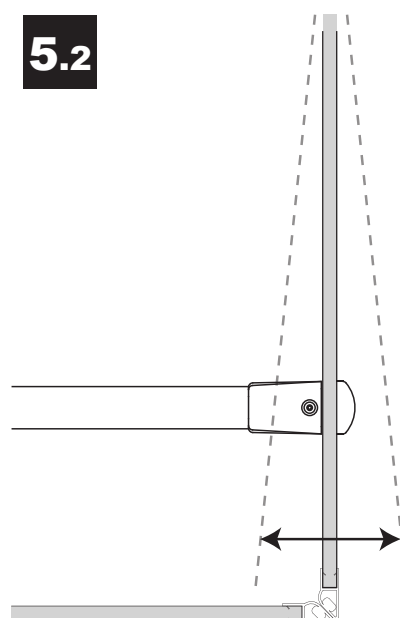

**5.3**

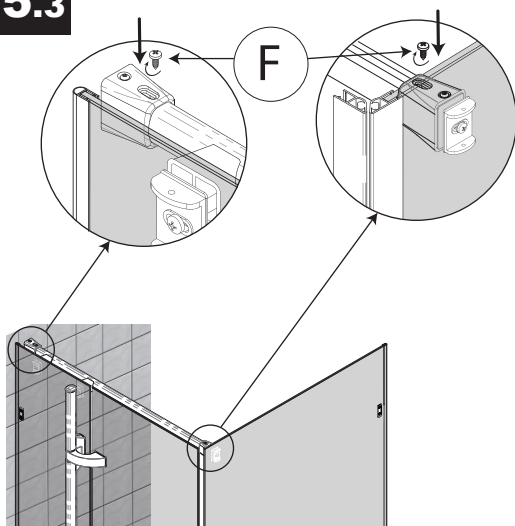

**5.4**

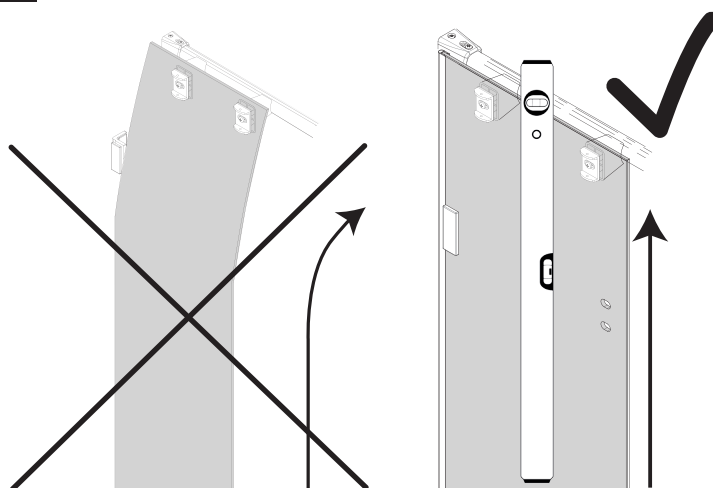



**5.5**

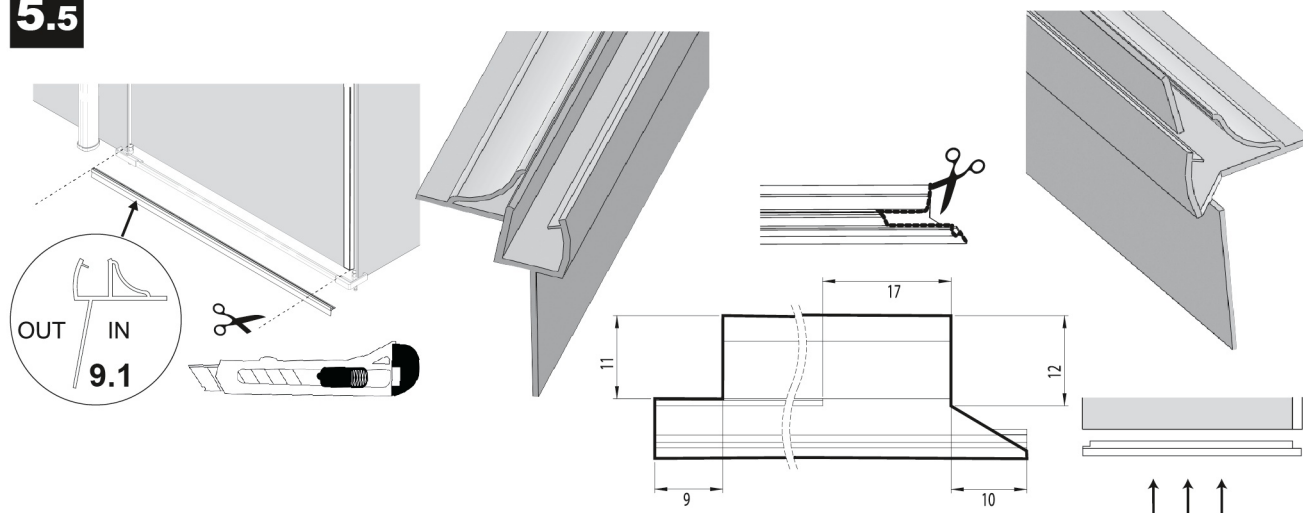

**6**

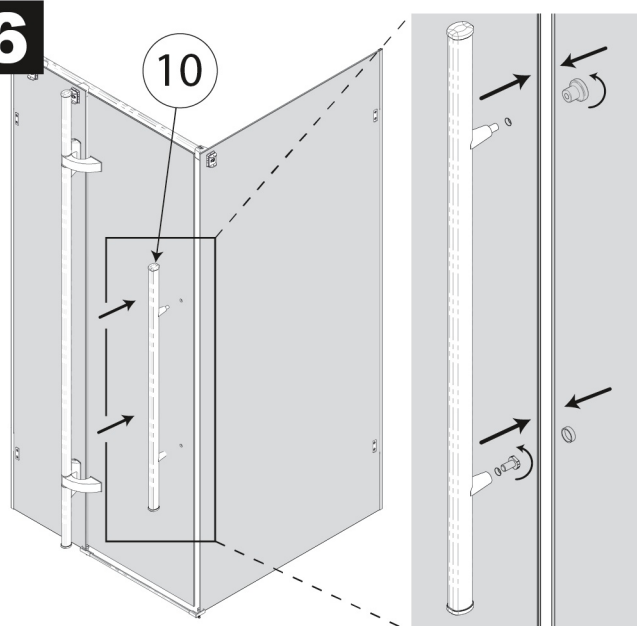

**6.1**

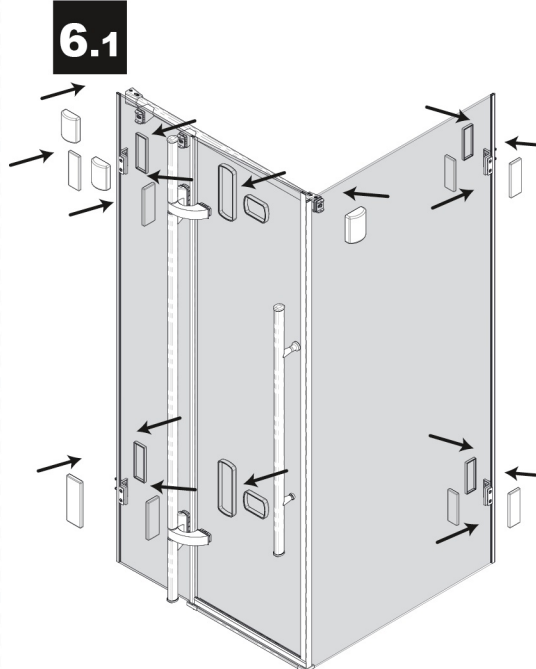

**6.2**

